

1 2 3 4 5 6 7 8

REVISIONS				
ISS	ZONE	DESCRIPTION	PER REQUEST	DATE
B	A-1	NO.2 WAS CHANGED	RD-DM89011401B	01-14-00
C	A-1	NO.1 WAS CHANGED	RD-DM89082401Y	08-24-00
D	A-1	NO.3 WAS CHANGED	RD-DM90091401H	09-14-01
		NO.2 WAS CHANGED	RD-DM90092801L	09-28-01

SALES

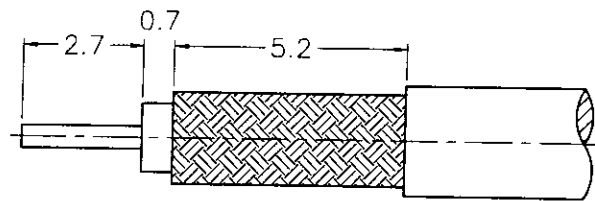

RECOMMENDED
CABLE STRIPPING DIM'S
(建議剝線尺寸)

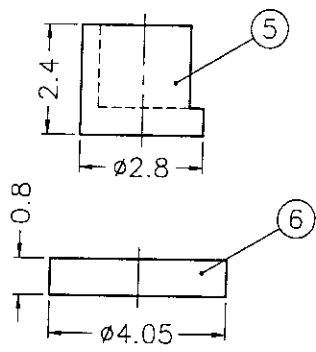
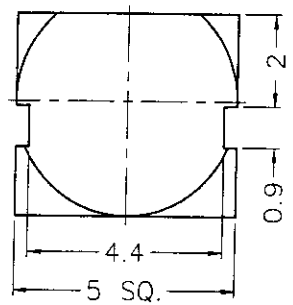
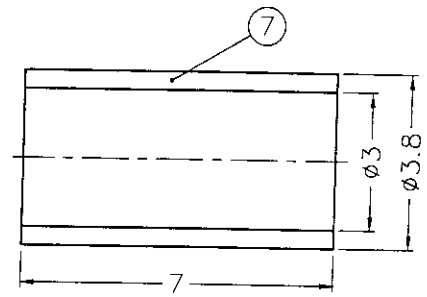
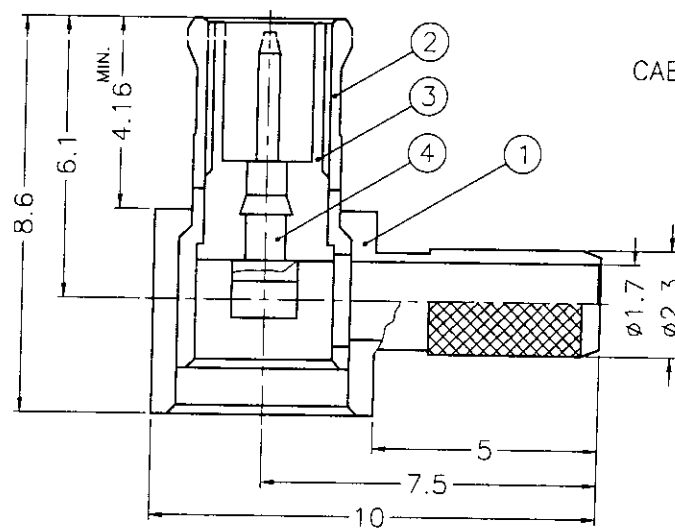

ISSUED
2001 10. 19
R & D

- 1. CRIMPED FERRULE
HEX CRIMP SIZE .128"
- 2. CONTACT PIN TO SOLDER

NOTES: FINISH (PLATING THICKNESS IN MICRO-INCHES)
 1. BRASS PER QQ-B-626
 2. BRASS PER QQ-B-613
 3. NICKEL PL. 100 MIN. THICK OVER COPPER STRIKE
 4. GOLD PL. 30 MIN. THICK OVER NICKEL PL. 100 MIN. THICK OVER COPPER STRIKE
 5. TEFLON MIL-P-19468
 6. BERYLLIUM COPPER PER QQ-C-530

NO.	DESCRIPTION	MATERIAL	FINISH	Q'TY	DRAWING NO.
7	FERRULE	COPPER	NOTE 3	1	FR-38/3X7C
6	COVER	NOTE 2	NOTE 3	1	CV-405X08-T
5	INSULATOR	DELTRIN	NATURAL	1	MCX1112A1-5
4	CONTACT PIN	NOTE 1	NOTE 4	1	MCX1112A1-4
3	INSULATOR	NOTE 5	NATURAL	1	MCX1112A1-3T-50-C
2	BODY	NOTE 6	NOTE 3	1	B008AAN01E
1	HOUSING	NOTE 1	NOTE 3	1	MCX1112A1-1-23/17-D

DIMENSIONS ARE IN MILLIMETERS		PART NO.	
UNLESS OTHERWISE SPECIFIED TOLERANCES		APPROVED	DATE
0.5-6 = ±0.2		<i>Mark C</i>	10-18-01
6-30 = ±0.4		CHECKED	DATE
30-120 = ±0.6		<i>Karl J.</i>	10-18-01
120-315 = ±1		DRAWN	DATE
315-1000 = ±1.6		<i>Joyce Y.</i>	10-18-01
1000-2000 = ±2.4			

Amphenol - Kai Jack
TAINAN TAIWAN

TITLE MCX R/A CRIMP PLUG
(FOR RG-174/U, 188A/U, 316/U)

DRAWING NO. KJ-MCX1112A1-NT30G-316U-50

ITEM NO. 081112AAA36NC5F

NO.	DESCRIPTION	MATERIAL	FINISH	Q'TY	DRAWING NO.	SCALE	6/1	ISSUE	D	FILE NO.
										F:\DWG\MCX\1112A1\316U-50\NT30G