

ISS	ZONE	DESCRIPTION\PER REQUEST\DATE
B	A-1	NO.1 WAS CHANGED\RD-DM89042001C\04-20-00'
C	B-1	NO.7 WAS CHANGED\RD-DM89083101Y\08-31-00'

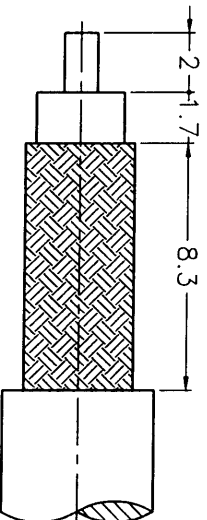

RECOMMENDED
CABLE STRIPPING DIM'S
(建議剝線尺寸)

業務部

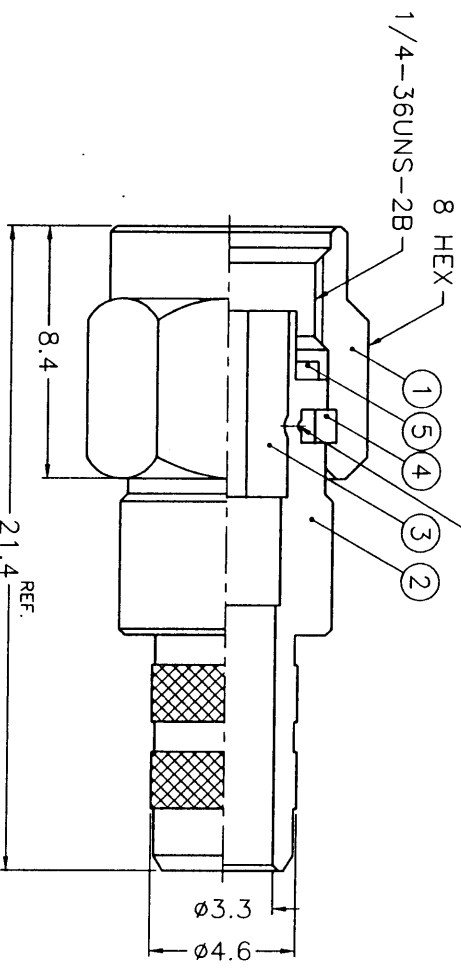

STAKE IN 4 PLACES
EQUALLY SPACED 90° APART
(打四點 間隔 90°)
(SEE REMARK 1,2)

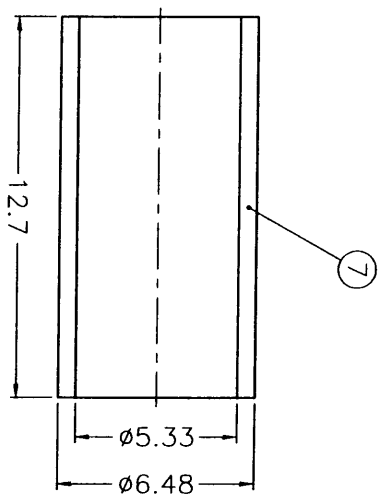
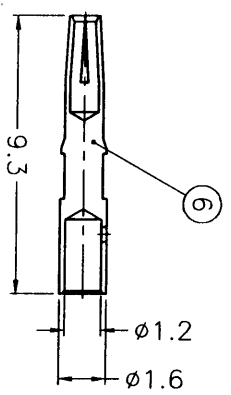

NOTES: FINISH (PLATING THICKNESS IN MICRO-INCHES)
 1. BRASS PER 00-8-626
 2. NICKEL PL. 100 MIN. THICK OVER COPPER STRIKE
 3. BERYLLIUM COPPER PER QQ-C-530
 4. GOLD PL. 50 MIN. THICK OVER NICKEL PL. 100 MIN. THICK OVER COPPER STRIKE
 5. TEFLON MIL-P-19468

1. CRIMPED FERRULE
HEX CRIMP SIZE .213"
2. CONTACT PIN TO SOLDER



REMARK:1. NO.3 MUST WITHSTAND A 6 lbs. MIN. PUSHOUT FORCE FROM NO.2 AFTER STAKING OPERATION
 2. REMARK1 IS MAINTAINED BY STAMPING THE FOUR POINTS SHOWN ON THE DRAWING WITHOUT PUNCTURING NO.2
 (1. 打四點後零件 3 由零件 2 推出至少必須承受 6 磅推力)
 (2. 打四點後除需符合備註 1 要求外 且不可擊穿零件 2)

NO.	DESCRIPTION	MATERIAL	FINISH	Q'TY	DRAWING NO.
1	SHELL	NOTE 1	NOTE 2	1	SMA5000-1-C
2	BODY	NOTE 1	NOTE 2	1	SMA1111A1-L200
3	INSULATOR	NOTE 5	NATURAL	1	SMA1111A1-L200
4	RETAINER RING	NOTE 3	NATURAL	1	SMA5000-4-B
5	GASKET	SILICONE	RED	1	GS-6/43X06
6	CONTACT PIN	COPPER	NOTE 3	1	FR-648/533X127C
7	FERRULE	COPPER	NOTE 2	1	FR-648/533X127C

DIMENSIONS ARE IN MILLIMETERS
UNLESS OTHERWISE SPECIFIED

TOLERANCES
 0.5-6 = ±0.2
 6-30 = ±0.4
 30-120 = ±0.6
 120-315 = ±1
 315-1000 = ±1.6
 1000-2000 = ±2.4

APPROVED
 CHECKED
 DRAWN

DATE
 DATE
 DATE

TITLE
Amphenol - Kai Jack
 TAINAN TAIWAN
 SMA REVERSE POLARITY CRIMP PLUG
 (FOR TIMES LMR-200)
 DRAWING NO.
 KJ-RSMA1111A1-NT50G-LMR200-50
 FILE NO. F:\DWG\RSMA\1111A1\200\50\NT50G