

REVISIONS		
ISS	ZONE	DESCRIPTION\PER REQUEST\DATE

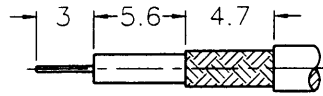

RECOMMENDED  
CABLE STRIPPING DIM'S  
(建議剝線尺寸)

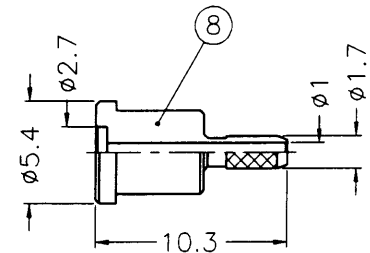
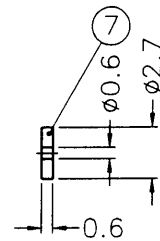
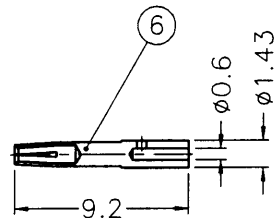
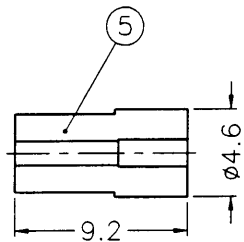
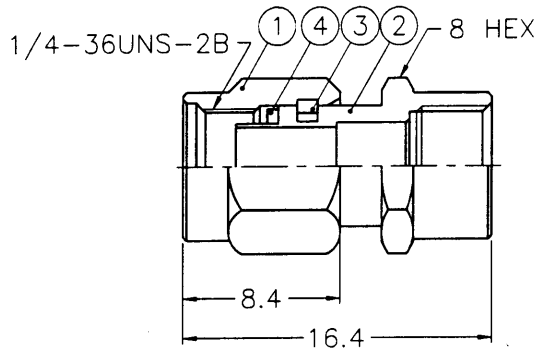

NOTES: FINISH (PLATING THICKNESS IN MICRO-INCHES)

- BRASS PER QQ-B-626
- GOLD PL. 3 MIN. THICK OVER NICKEL PL. 100 MIN. THICK OVER COPPER STRIKE
- BERYLLIUM COPPER PER QQ-C-530
- GOLD PL. 50 MIN. THICK OVER NICKEL PL. 100 MIN. THICK OVER COPPER STRIKE
- TEFLON MIL-P-19468

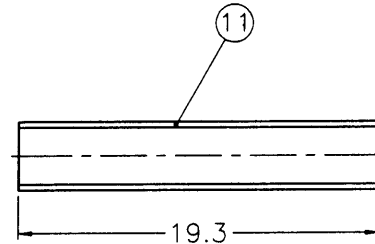
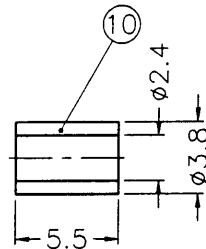
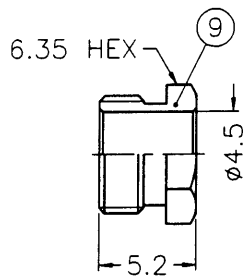

1. CRIMPED FERRULE  
HEX CRIMP SIZE .128"

NO.	DESCRIPTION	MATERIAL	FINISH	Q'TY	DRAWING NO.
11	HEAT SHRINK TUBING			1	HT-36/3X193
10	FERRULE	COPPER	NOTE 2	1	FR-38/24X55C
9	HEX NUT	NOTE 1	NOTE 2	1	SMA5003-9-635/45
8	BARREL	NOTE 1	NOTE 2	1	SMA1111G2-8-17/1
7	INSULATOR	NOTE 5	NATURAL	1	SMA1111G2-7
6	CONTACT PIN	NOTE 3	NOTE 4	1	RSMA1111G2-6-143/06
5	INSULATOR	NOTE 5	NATURAL	1	RSMA1111G2-5T-50
4	GASKET	SILICONE	RED	1	GS-6/43X06
3	RETAINER RING	NOTE 3	NATURAL	1	SMA5000-4-B
2	BODY	NOTE 1	NOTE 2	1	RSMA1111G2-2
1	SHELL	NOTE 1	NOTE 2	1	SMA5000-1-B

DIMENSIONS ARE IN MILLIMETERS			
UNLESS OTHERWISE SPECIFIED TOLERANCES			
0.5-6	=	±0.2	
6-30	=	±0.4	
30-120	=	±0.6	
120-315	=	±1	
315-1000	=	±1.6	
1000-2000	=	±2.4	
SCALE	2.5/1	ISSUE	A

PART NO.	
APPROVED	<i>[Signature]</i> DATE 01-31-00'
CHECKED	<i>[Signature]</i> DATE 01-31-00'
DRAWN	<i>[Signature]</i> DATE 01-31-00'

<b>Amphenol - Kai Jack</b>	
TAINAN TAIWAN	
TITLE	SMA REVERSE POLARITY CRIMP PLUG (FOR RG-178B/U,196A/U)
DRAWING NO.	KJ-RSMA1111G2-3GT50G-196AU-50
FILE NO.	F:\DWG\RSMA\1111G2\196AU-50\3GT50G