

1 2 3 4 5 6 7 8

REVISIONS			
ISS	ZONE	DESCRIPTION	PER REQUEST\DATE

業務部

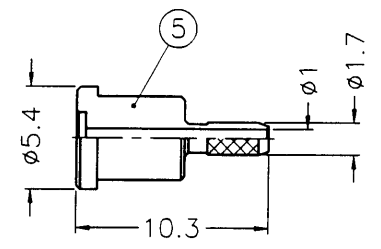
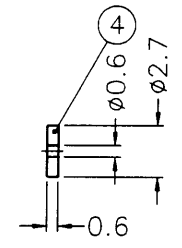
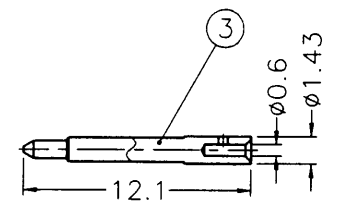
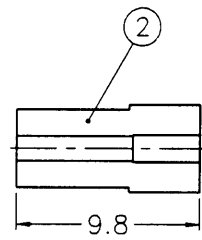
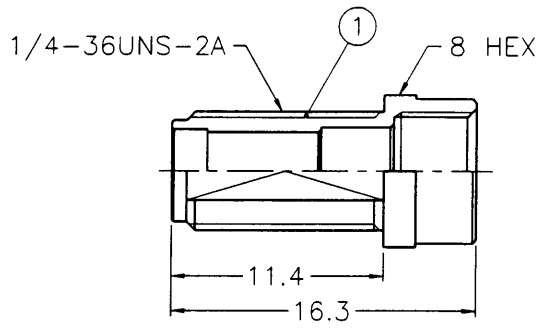
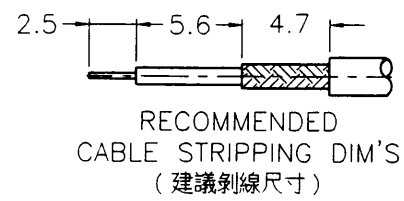

NOTES: FINISH (PLATING THICKNESS IN MICRO-INCHES)
 1. BRASS PER QQ-B-626
 2. BRASS PER QQ-B-613
 3. GOLD PL. 3 MIN. THICK OVER NICKEL PL. 100 MIN. THICK OVER COPPER STRIKE
 4. GOLD PL. 50 MIN. THICK OVER NICKEL PL. 100 MIN. THICK OVER COPPER STRIKE
 5. TEFLON MIL-P-19468

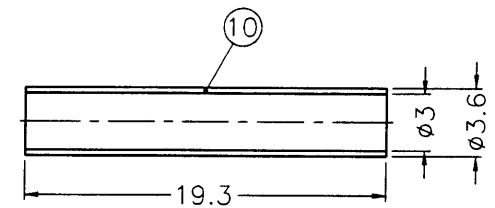
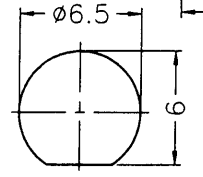
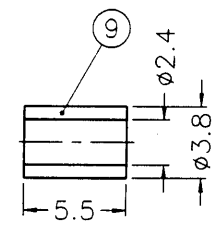
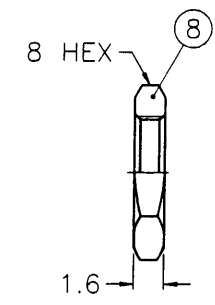
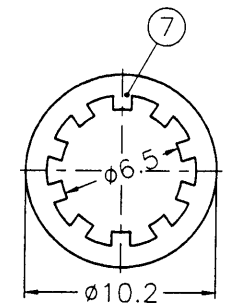
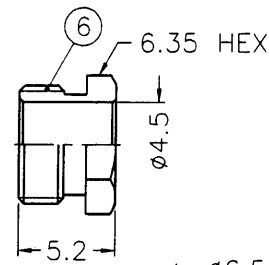

89.2.02
R&D

1. CRIMPED FERRULE
HEX CRIMP SIZE .128"

10	HEAT SHRINK TUBING			1	HT-36/3X193
9	FERRULE	COPPER	NOTE 3	1	FR-38/24X55C
8	HEX NUT	NOTE 1	NOTE 3	1	HN8-1/4-36X16
7	LOCK WASHER	NOTE 2	NOTE 3	1	LW-102/65X05
6	HEX NUT	NOTE 1	NOTE 3	1	SMA5003-9-635/45
5	BARREL	NOTE 1	NOTE 3	1	SMA1111G2-8-17/1
4	INSULATOR	NOTE 5	NATURAL	1	SMA1111G2-7
3	CONTACT PIN	NOTE 1	NOTE 4	1	RSMA6411G2-3-143/06
2	INSULATOR	NOTE 5	NATURAL	1	SMA6411G2-2T-50
1	BODY	NOTE 1	NOTE 3	1	SMA7403-1-B
NO.	DESCRIPTION	MATERIAL	FINISH	Q'TY	DRAWING NO.

DIMENSIONS ARE IN MILLIMETERS			
UNLESS OTHERWISE SPECIFIED TOLERANCES			
0.5-6	=	±0.2	
6-30	=	±0.4	
30-120	=	±0.6	
120-315	=	±1	
315-1000	=	±1.6	
1000-2000	=	±2.4	
SCALE	2.5/1	ISSUE	A

PART NO.	
APPROVED	DATE 02-01-00'
CHECKED	DATE 02-01-00'
DRAWN	DATE 02-01-00'

Amphenol - Kai Jack	
TAINAN TAIWAN	
TITLE	SMA REVERSE POLARITY BULKHEAD CRIMP JACK (FOR 178B/U,196A/U)
DRAWING NO.	KJ-RSMA6411G2-3GT50G-196AU-50
FILE NO.	F:\DWG\RSMA\6411G2\196AU-50\3GT50G

1 2 3 4 5 6 7 8 801