

REVISONS	
ISS	DESCRIPTION \ PER REQUEST \ DATE
B	A-1 NO.1 WAS CHANGED \ RD--DM89042001C \ 04-20-00'

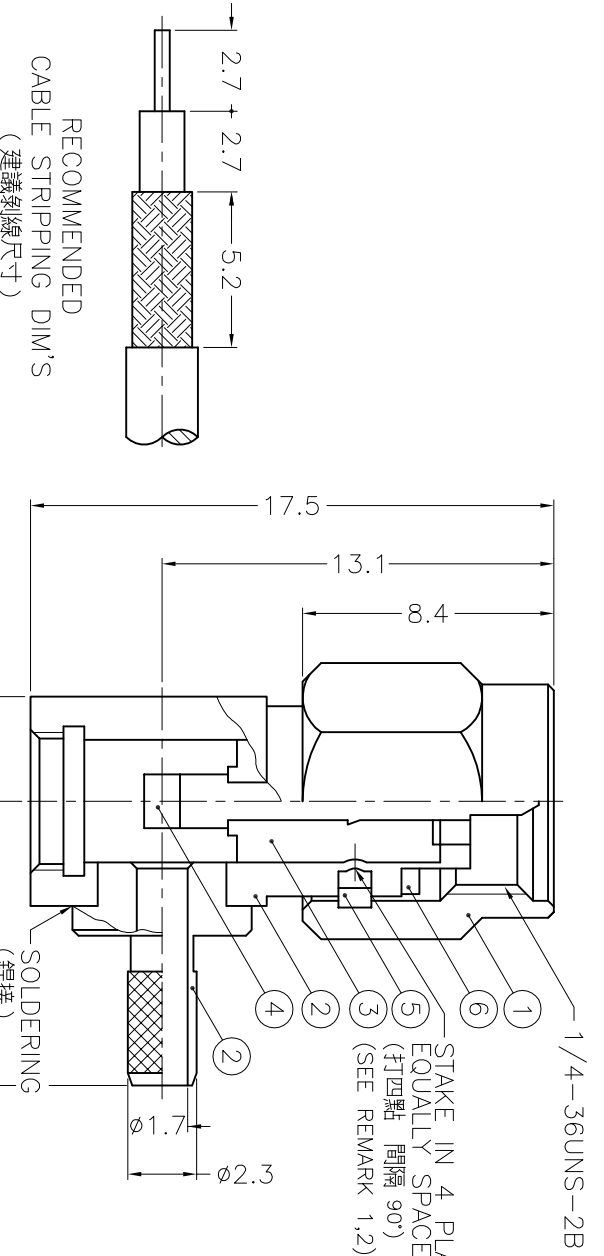

REMARK: 1. NO.3 MUST WITHSTAND A 6 lbs. MIN. PUSHOUT FORCE FROM NO.2 AFTER STAKING OPERATION  
 2. REMARK 1 IS MAINTAINED BY STAMPING THE FOUR POINTS SHOWN ON THE DRAWING WITHOUT PUNCTURING NO.2  
 (1. 打四點後零件 3 由零件 2 推出至少必須承受 6 磅推力)  
 (2. 打四點後除需符合備註 1 要求外 且不可擊穿零件 2 )

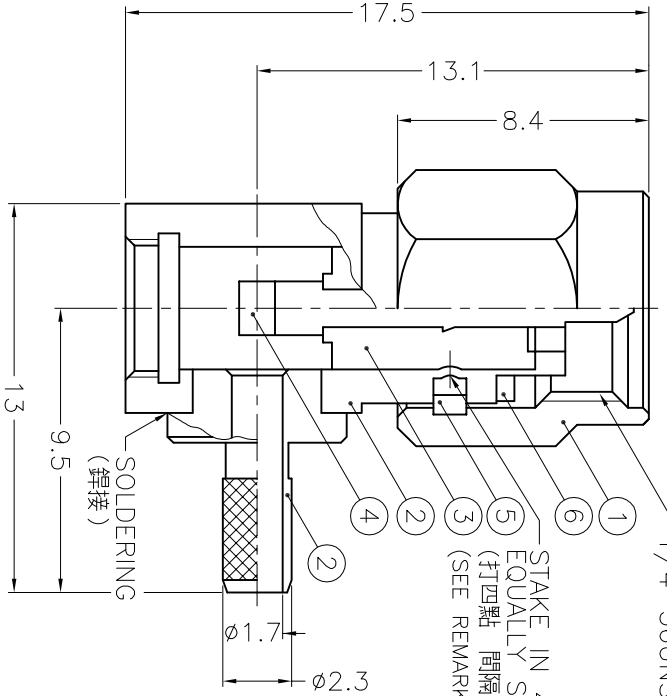

1. CRIMPED FERRULE  
 HEX CRIMP SIZE ".128"

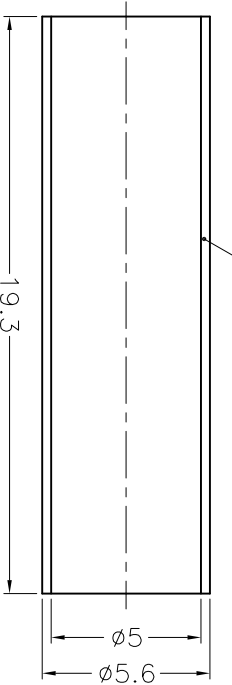

NOTES: FINISH (PLATING THICKNESS IN MICRO-INCHES)  
 1. BRASS PER QQ-B-626  
 2. GOLD PL. 3 MIN. THICK OVER NICKEL PL. 100 MIN. THICK OVER COPPER STRIKE  
 3. BERYLLIUM COPPER PER QQ-C-530  
 4. GOLD PL. 50 MIN. THICK OVER NICKEL PL. 100 MIN. THICK OVER COPPER STRIKE  
 5. TEFLON MIL-P-19468

9	HEAT SHRINK TUBING		1	HT-56/5X193
8	FERRULE	COPPER	1	FR-38/3X7C
7	COVER	NOTE 1	1	DMT-2004-004N-8
6	GASKET	SILICONE	1	GS-6/43X06
5	RETAINER RING	NOTE 3	1	SMA5000-4-B
4	CONTACT PIN	NOTE 1	1	SMA1112A7-4-18/12
3	INSULATOR	NOTE 5	1	SMA1112A7-3T-50
2	HOUSING WITH BARREL	NOTE 1	1	SMA1112A5-2S-23/17
1	SHELL	NOTE 1	1	SMA5000-1-C

DIMENSIONS ARE IN MILLIMETERS  
 UNLESS OTHERWISE SPECIFIED  
 TOLERANCES  
 0.5-6 = ±0.2  
 6-30 = ±0.4  
 30-120 = ±0.6  
 120-315 = ±1  
 315-1000 = ±1.6  
 1000-2000 = ±2.4

PART NO.		DRAWING NO.	
APPROVED		DATE	
CHECKED		DATE	
DRAWN		DATE	
TITLE		FILE NO.	
SMA R/A CRIMP PLUG (FOR RG-174/U, 188A/U, 316/U )		F:\DWG\SMA\1112A5\316U-50\36T50G	
DRAWING NO.		DATE	
KU-SMA1112A5-36T50G-316U-50		06-29-00'	

**Amphenol - Kai Jack**  
 TAINAN TAIWAN

A

A