

REVISIONS		
ISS	ZONE	DESCRIPTION\PER REQUEST\DATE
A1	B-4	TEXT WAS CHANGED\N/A\10-16-02'
B	A-1	NO.4 WAS CHANGED AND NO.7, NO.8 DELETE \RD-DM91102401K\10-24-02'

SALES

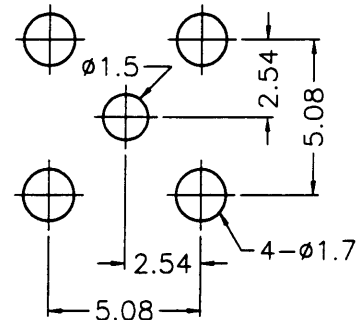

PCB MOUNTING HOLE
(印刷电路板架設孔)

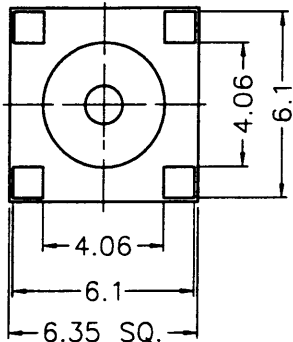
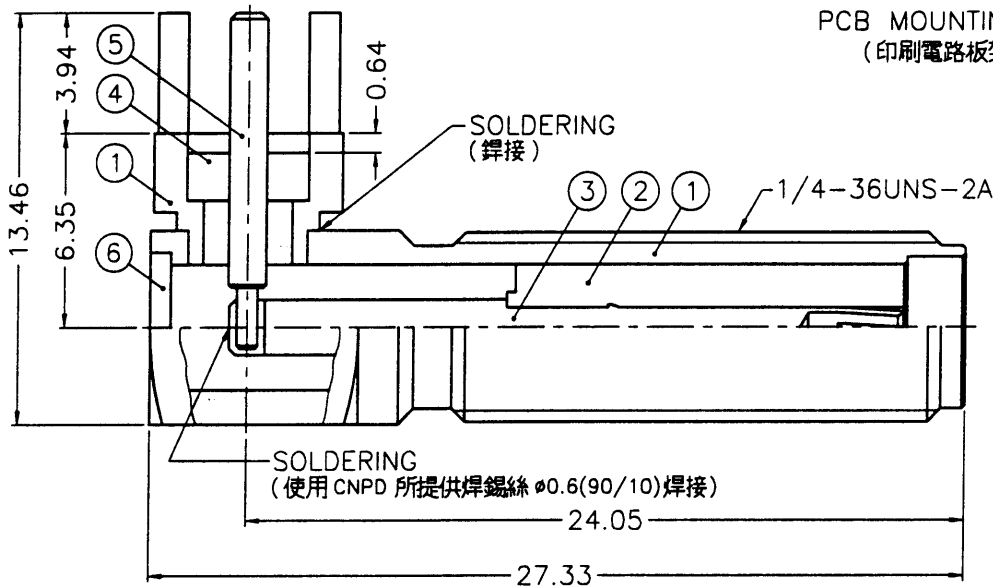

NOTES: FINISH (PLATING THICKNESS IN MICRO-INCHES)

- BRASS PER QQ-B-626
- BRASS PER QQ-B-613
- BERYLLIUM COPPER PER QQ-C-530
- TEFLON MIL-P-19468
- GOLD PL. 50 MIN. THICK OVER NICKEL PL. 100 MIN. THICK OVER COPPER STRIKE
- GOLD PL. 10 MIN. THICK OVER NICKEL PL. 100 MIN. THICK OVER COPPER STRIKE

ISSUED
2002. 10. 29
R & D

NO.	DESCRIPTION	MATERIAL	FINISH	Q'TY	DRAWING NO.
6	COVER			1	CV-5X05-T
5	CONTACT PIN			1	SMA6252A1-001-5
4	INSULATOR		NATURAL	1	NS00AGM27A
3	CONTACT PIN			1	SMA6252A1-001-3
2	INSULATOR		NATURAL	1	SMA6252A1-001-2
1	HOUSING WITH BODY			1	SMA6252A1-001-1S

DIMENSIONS ARE IN MILLIMETERS				PART NO.	
UNLESS OTHERWISE SPECIFIED TOLERANCES				APPROVED	DATE
0.5-6	= ±0.2	6-30	= ±0.4	<i>Jacky</i>	10-24-02'
30-120	= ±0.6	120-315	= ±1	<i>Ken</i>	10-24-02'
315-1000	= ±1.6	1000-2000	= ±2.4	<i>Ken</i>	10-24-02'
SCALE	4/1	ISSUE	B	DRAWN	DATE
FILE NO.	F:\DWG\SMA\6252A1\001\50\10GT50G				

Amphenol	
Danbury, CT, USA - Tainan, Taiwan - Shenzhen, China	
TITLE	SMA R/A P.C.B BULKHEAD JACK
DRAWING NO.	KJ-SMA6252A1-001-10GT50G-50
ITEM NO.	116252AAD01GK5F

7RD-DK 15820 8