

ISS	ZONE	DESCRIPTION\PER REQUEST\DATE
A1	A-2	SMA6411G2-2T-50 WAS SMA7403-2T-50 AND SMA6411G2-3-143/06 WAS SMA7403-18/06 \N/A\04-18-99'
A2	B-1	NO.10 WAS CHANGED\N/A\07-16-02'

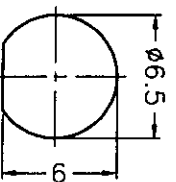

RECOMMENDED MOUNTING HOLE (建議架設孔)

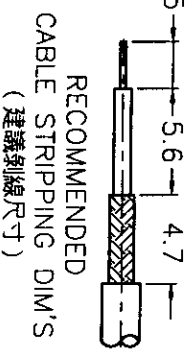

SALES

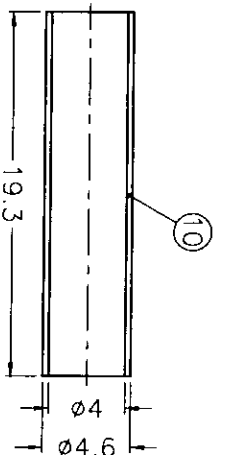
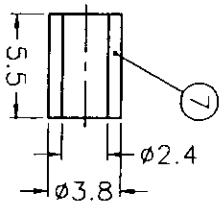
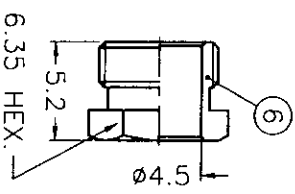
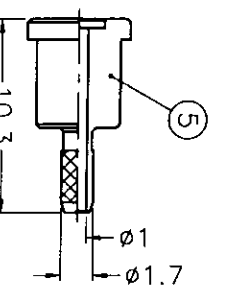
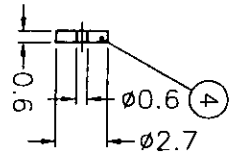
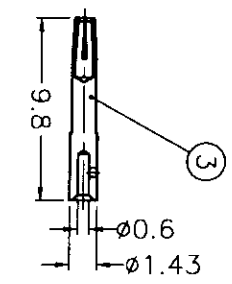
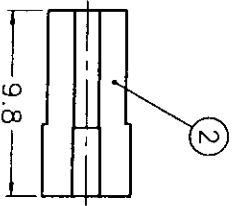
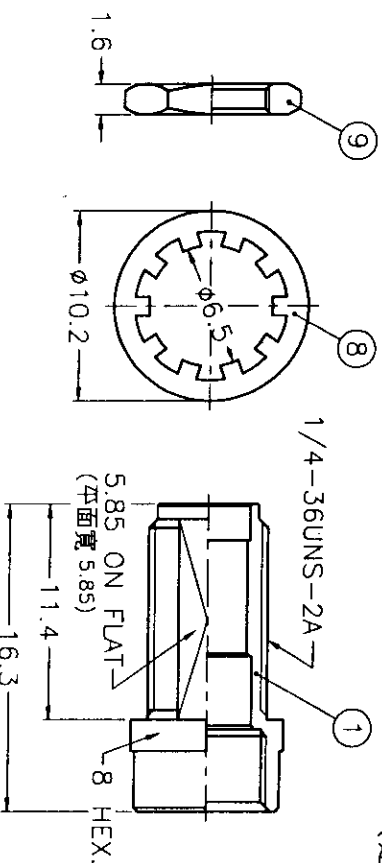

ISSUED
2002.7.13
R&D

NOTES: FINISH (PLATING THICKNESS IN MICRO-INCHES)

- BRASS PER QQ-B-626
- BRASS PER QQ-B-613
- GOLD PL. 3 MIN. THICK OVER NICKEL PL. 100 MIN. THICK OVER COPPER STRIKE
- BERYLLIUM COPPER PER QQ-C-530
- GOLD PL. 50 MIN. THICK OVER NICKEL PL. 100 MIN. THICK OVER COPPER STRIKE
- TEFLON MIL-P-19468

NO.	DESCRIPTION	MATERIAL	FINISH	Q'TY	DRAWING NO.
10	HEAT SHRINK TUBING		BLACK	1	HT-46/4X193
9	HEX NUT	NOTE 1	NOTE 3	1	HN8-1/4-36X16
8	LOCK WASHER	NOTE 2	NOTE 3	1	LW-102/65X05
7	FERRULE	COPPER	NOTE 3	1	FR-38/24X55C
6	HEX NUT	NOTE 1	NOTE 3	1	SMA5003-9-635/45
5	BARREL	NOTE 1	NOTE 3	1	SMA1111G2-8-17/1
4	INSULATOR	NOTE 6	NATURAL	1	SMA1111G2-7
3	CONTACT PIN	NOTE 4	NOTE 5	1	SMA6411G2-3-143/06
2	INSULATOR	NOTE 6	NATURAL	1	SMA6411G2-2T-50
1	BODY	NOTE 1	NOTE 3	1	SMA7403-1-B

DIMENSIONS ARE IN MILLIMETERS
UNLESS OTHERWISE SPECIFIED

TOLERANCES
0.5-6 = ±0.2
6-30 = ±0.4
30-120 = ±0.6
120-315 = ±1
315-1000 = ±1.6
1000-2000 = ±2.4

APPROVED
DATE 07-16-02'
CHECKED
DATE 07-16-02'
DRAWN
DATE 07-16-02'

PART NO.

Amphenol - Kai Jack

TAINAN TAIWAN

TITLE
SMA BULKHEAD CRIMP JACK
(FOR 178B/U, 196A/U)

DRAWING NO.
KJ-SMA6411G2-3GT50G-196AU-50

ITEM NO. 116411AAE16GA5F

1 2 3 4 5 6 7 8

7 PD-DP / 49078