

ISS ZONE	DESCRIPTION \ PER REQUEST \ DATE
A1 B-1	NO.10 WAS CHANGED \ N/A \ 07-16-02'

REVISIONS

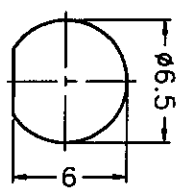

RECOMMENDED MOUNTING HOLE  
(建議架設孔)

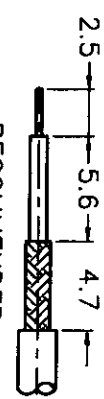

RECOMMENDED CABLE STRIPPING DIM'S  
(建議剝線尺寸)

**SALES**

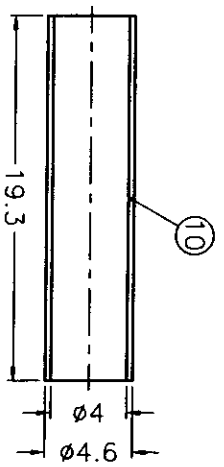
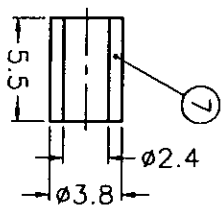
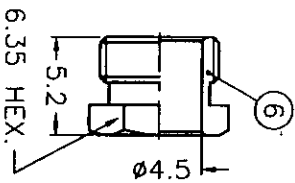
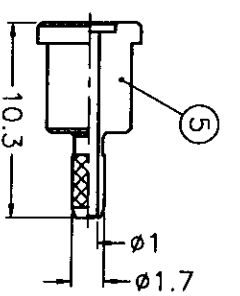
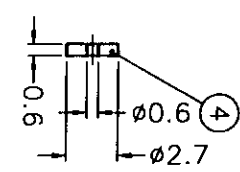
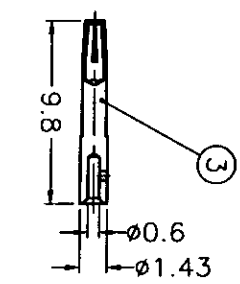
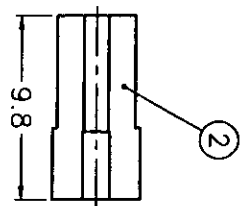
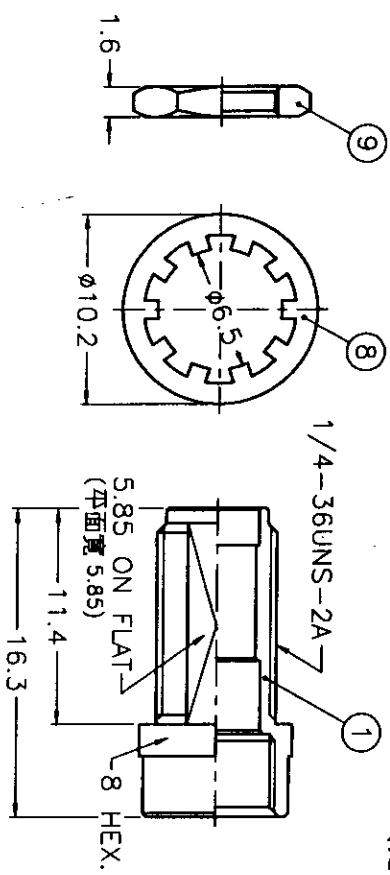

ISSUED  
2002.7.18  
R&D

NOTES: FINISH (PLATING THICKNESS IN MICRO-INCHES)

1. BRASS PER 00-B-626
2. BRASS PER 00-B-613
3. NICKEL PL. 100 MIN. THICK OVER COPPER STRIKE
4. BERYLLIUM COPPER PER 00-C-530
5. GOLD PL. 50 MIN. THICK OVER NICKEL PL. 100 MIN. THICK OVER COPPER STRIKE
6. TEFLON MIL-P-19468

1. CRIMPED FERRULE HEX. CRIMP SIZE .128"
2. CONTACT PIN TO SOLDER

10	HEAT SHRINK TUBING	BLACK	1	HT-46/4X193
9	HEX NUT	NOTE 1	NOTE 3	HNB-1/4-36X16
8	LOCK WASHER	NOTE 2	NOTE 3	LW-102/65X05
7	FERRULE	COPPER	NOTE 3	FR-38/24X55C
6	HEX NUT	NOTE 1	NOTE 3	SMA5003-9-635/45
5	BARREL	NOTE 1	NOTE 3	SMA1111G2-8-17/1
4	INSULATOR	NOTE 6	NATURAL	SMA1111G2-7
3	CONTACT PIN	NOTE 4	NOTE 5	SMA6411G2-3-143/06
2	INSULATOR	NOTE 6	NATURAL	SMA6411G2-2T-50
1	BODY	NOTE 1	NOTE 3	SMA7403-1-B

DIMENSIONS ARE IN MILLIMETERS  
UNLESS OTHERWISE SPECIFIED

TOLERANCES
0.5-6 = ±0.2
6-30 = ±0.4
30-120 = ±0.6
120-315 = ±1
315-1000 = ±1.6
1000-2000 = ±2.4

APPROVED	DATE
<i>[Signature]</i>	07-16-02'
CHECKED	DATE
<i>[Signature]</i>	07-16-02'
DRAWN	DATE
<i>[Signature]</i>	07-16-02'

**Amphenol - Kai Jack**  
TAINAN TAIWAN

TITLE  
SMA BULKHEAD CRIMP JACK  
(FOR 1788/U,196A/U)

DRAWING NO. KJ-SMA6411G2-NT50G-196AU-50  
ITEM NO. 116411AAE16NE5F

1 2 3 4 5 6 7 8

7 PD-DE 1229048