

REVISIONS			
ISS	ZONE	DESCRIPTION	APPROVED \ DATE
A	A-7	SMB6121G1 WAS SMB5003 \ TONY. T \ 09-24-93'	
B	A-1	NO.2 AND NO.4 WERE CHANGED \ TONY. T \ 12-28-94'	
C	A-1	NO.4 WAS CHANGED \ TONY. T \ 06-15-95'	

業務部

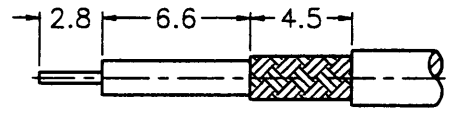

RECOMMENDED  
CABLE STRIPPING DIM'S

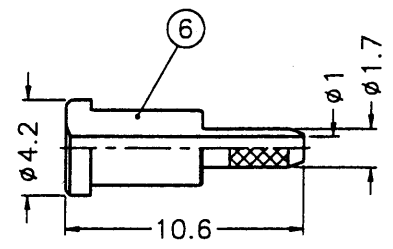
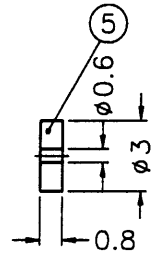
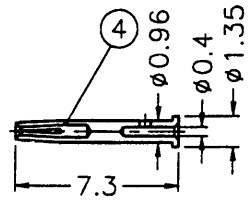
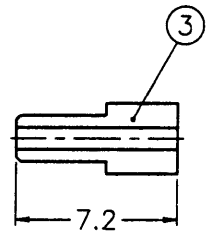
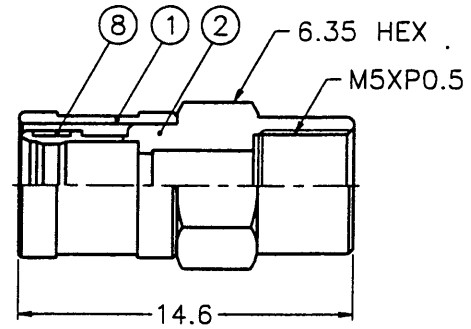

- NOTES: FINISH (PLATING THICKNESS IN MICRO-INCHES)
1. BRASS PER QQ-B-626, ALLOY 360, 1/2 H
  2. NICKEL PL. 100 MIN. OVER COPPER PL. 50 MIN. GOLD PL. MIN. OVER NICKEL PL. 50 MIN. OVER COPPER PL. 50 MIN.
  3. BERYLLIUM COPPER PER QQ-C-530, ALLOY 173, 1/2 H
  4. GOLD PL. 30 MIN. OVER NICKEL PL. 50 MIN. OVER COPPER PL. 50 MIN.
  5. TEFLON MIL-P-19468

出圖  
84.6.19  
品保部

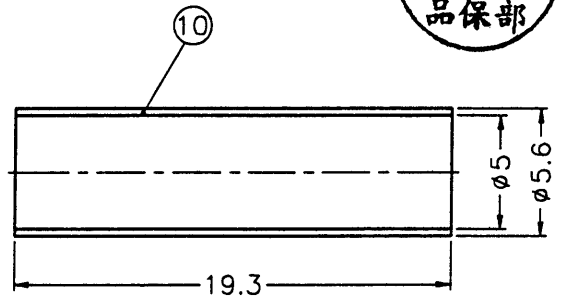
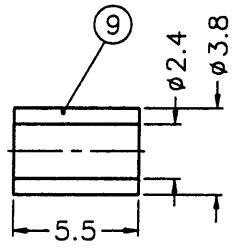
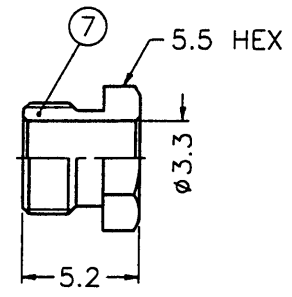

10	HEAT SHRINK TUBING			1	SMA5003-11
9	FERRULE	COPPER	NOTE 2	1	SMB5090-9-38 \ 24C
8	RETAINER RING		NOTE 3	1	NATURAL SMB5000-6
7	HEX NUT		NOTE 1	1	NOTE 2 SMB5003-7-55 \ 33
6	BARREL		NOTE 1	1	NOTE 2 SMB5003-6-17 \ 1
5	INSULATOR		NOTE 5	1	NATURAL SMB5003-5
4	CONTACT PIN		NOTE 3	1	NOTE 4 SMB5003-4-135 \ 04-B
3	INSULATOR		NOTE 5	1	NATURAL SMB5003-3T-50
2	BODY		NOTE 1	1	NOTE 2 SMB5003-2-A
1	SHELL		NOTE 1	1	NOTE 2 SMB5000-1

DIMENSIONS ARE IN MILLIMETERS  
UNLESS OTHERWISE SPECIFIED TOLERANCES

0.5-6	= ±0.2
6-30	= ±0.4
30-120	= ±0.6
120-315	= ±1
315-1000	= ±1.6
1000-2000	= ±2.4

PART NO.	
APPROVED	<i>Tony T.</i> DATE 06-15-95'
CHECKED	<i>Golden W</i> DATE 06-15-95'
DRAWN	<i>Golden W</i> DATE 06-15-95'

TITLE	SMB CRIMP PLUG (FOR RG-178B/U, 196A/U)
DRAWING NO.	KJ-SMB6121G1-196AU-50
FILE NO.	F:\DWG\SMB\6121G1\196AU-50