

1 2 3 4 5 6 7 8

REVISIONS			
ISS	ZONE	DESCRIPTION	PER REQUEST\DATE
B	B-1	NO.12 WAS CHANGED	RD-DM87101501B\10-15-98'

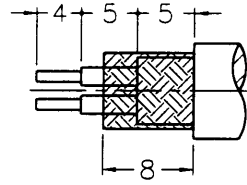

RECOMMENDED CABLE STRIPPING DIM'S

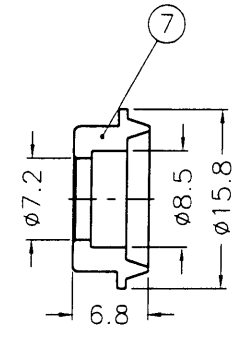
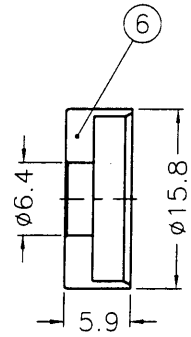
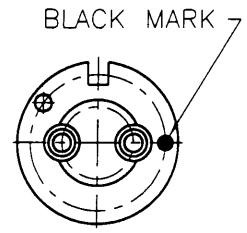
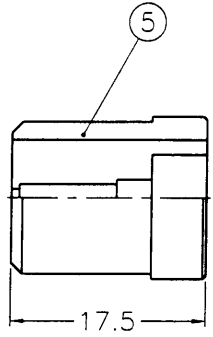
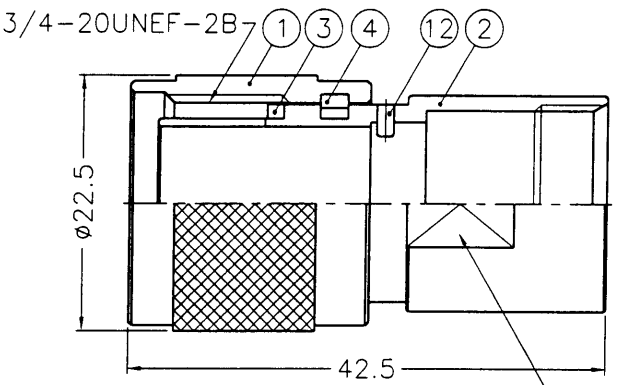

NOTES: FINISH (PLATING THICKNESS IN MICRO-INCHES)
 1. BRASS PER QQ-B-626
 2. BRASS PER QQ-B-613
 3. NICKEL PL. 100 MIN. THICK OVER COPPER STRIKE
 4. GOLD PL. 3 MIN. THICK OVER NICKEL PL. 100 MIN. THICK OVER COPPER STRIKE

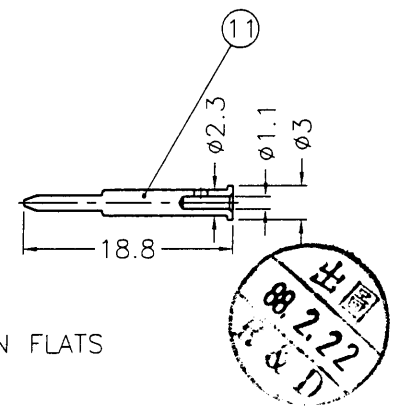
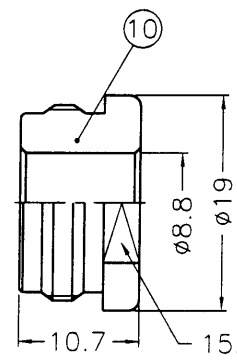
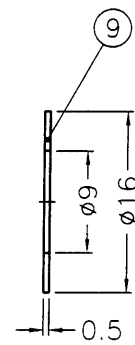
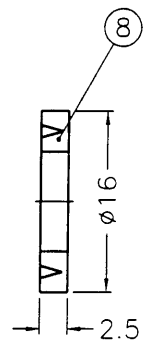

NO.	DESCRIPTION	MATERIAL	FINISH	Q'TY	DRAWING NO.
12	PIN			1	TW5620-12-B
11	CONTACT PIN			2	TW5620-11-3/11
10	NUT			1	TW5620-10-19/88
9	WASHER			1	WS-16/9X05
8	GASKET	SILICONE	RED	1	TW5620-8
7	BRAID CLAMP			1	TW5620-7-85/72
6	TOP HAT			1	TW5620-6-158/64
5	INSULATOR	PBT	WHITE	1	TW5620-5-B
4	RETAINER RING	SUS 304	NATURAL	1	N5000-7-C
3	GASKET	SILICONE	RED	1	GS-17/145X15
2	BODY			1	TW5620-2
1	SHELL			1	TW5620-1

DIMENSIONS ARE IN MILLIMETERS
 UNLESS OTHERWISE SPECIFIED TOLERANCES
 0.5-6 = ±0.2
 6-30 = ±0.4
 30-120 = ±0.6
 120-315 = ±1
 315-1000 = ±1.6
 1000-2000 = ±2.4

PART NO.	
APPROVED	<i>Mark C</i> DATE 02-10-99'
CHECKED	<i>Mark C</i> DATE 02-10-99'
DRAWN	<i>Betty S</i> DATE 02-10-99'

 KAI JACK INDUSTRIAL CO., LTD. TAINAN TAIWAN R.O.C.	TITLE	TWINAXIAL CLAMP PLUG (FOR BELDEN 9207)
	DRAWING NO.	KJ-TWX1141A1-NPB3G-9207-95
	FILE NO.	F:\DWG\TWX\1141A1\9207-95\NPB3G

F
E
D
C
B
A

F
E
D
C
B
A

1 2 3 4 5 6 7 8 8TWX R-28