

1 2 3 4 5 6 7 8

REVISIONS	
ISS	DESCRIPTION PER REQUEST DATE
A1	D-4 $\phi 2.87$ WAS $\phi 2.94$ \N/A\07-26-04'
B	A-3 NO.3 WAS CHANGED \RD-DM06072801C\08-14-06'
C	A-3 NO.4 WAS CHANGED \RD-DM06121501\12-19-06'
D	A-3 NO.4 WAS CHANGED \RD-DM07060601K\06-16-07'

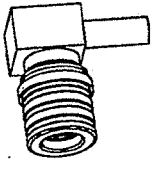

SCALE 1/1

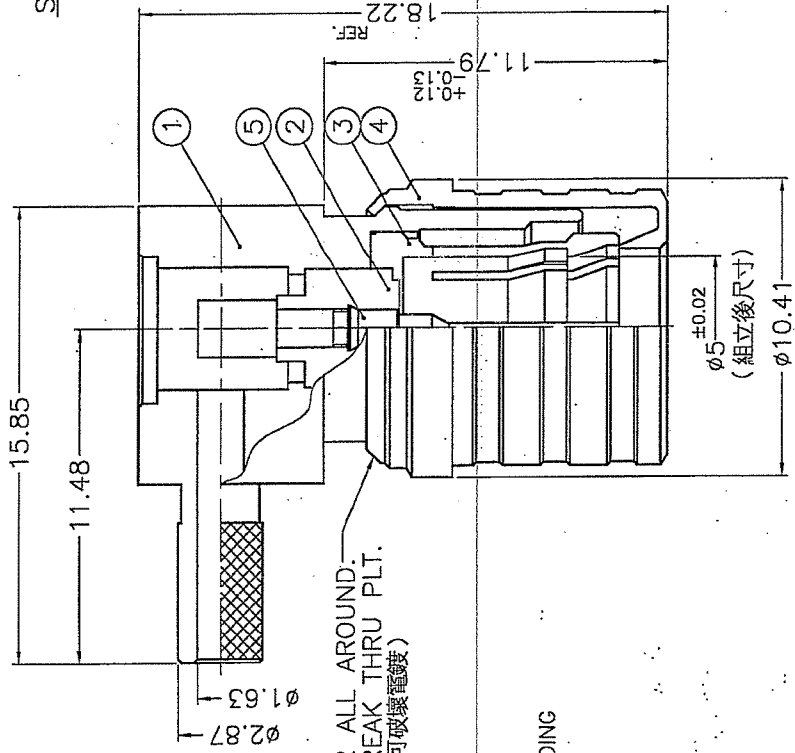

FORM OVER ALL AROUND.
DO NOT BREAK THRU PLT.
(全周成形, 不可破壞電鍍)

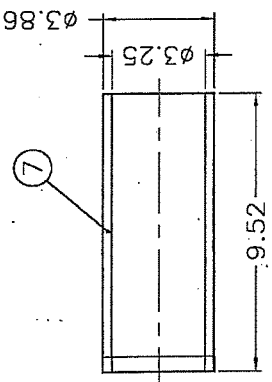

REMARK: 1. NO.5 IS A PRESS FIT INTO FRONT NO.2 AND MUST MEET INTERFACE DIMENSION AS SHOWN; SLOT SHOULD BE ORIENTED TO SIDE-HOLE AS SHOWN $\pm 2'$ (NO.5 組入 NO.2 後, 須符合圖面所標尺寸, 且 NO.5 的割溝與主體軸孔中心線平行 $\pm 2'$ 以內)
2. NO.4 MUST BE FREE TURNING AND MUST BE CAPABLE OF WITHSTANDING A PULL-OFF FORCE OF 30 LBS. MIN. AFTER FORMING (NO.4 成形後可自由轉動且至少需承受 30 LBS. 的拉力)
3. NO.5 MUST WITHSTAND AN AXIAL FORCE OF 6 LBS. AND MAINTAIN THE INTERFACE DIMENSIONS (NO.5 至少需承受 6 LBS. 的軸向推出力量且保持界面尺寸)

NOTES: FINISH (PLATING THICKNESS IN MICRO-INCHES)
1. BRASS PER QQ-B-626
2. PHOSPHOR BRONZE PER QQ-B-750
3. GOLD PL. 30 MIN. THICK OVER ALBLOY PLATING (COPPER-TIN-ZINC) PL. 80 MIN. THICK
4. ALBLOY PLATING (COPPER-TIN-ZINC) PL. 80 MIN. THICK
5. TEFLON MIL-P-19468

PART NO.		DATE	
7	FERRULE	31-1357-3	
6	CAP	901-6209-2	
5	CONTACT PIN	930-10050	
4	SLEEVE	930-10004	
3	OUTER CONTACT	930-10003/B	
2	INSULATOR	930-10010	
1	BODY	930-10051	

UNLESS OTHERWISE SPECIFIED TOLERANCES		DATE	
0.5-6	± 0.2	APPROVED	06-16-07'
6-30	± 0.4	CHECKED	06-16-07'
30-120	± 0.6	DRAWN	06-16-07'
120-315	± 1		
315-1000	± 1.6		
1000-2000	± 2.4		

SCALE	4/1	ISSUE	D	FILE NO.
				F:\DWG\CNPD\930\118P\51A-DSZ

NO.	DESCRIPTION	MATERIAL	FINISH	Q'TY	DRAWING NO.
1	DESCRIPTION				

Amphenol	
Danbury, CT, USA-Tainan, Taiwan-Shenzhen, China	
TITLE	QMA 50 OHM R/A PLUG FOR RG-316 TYPE CABLE
DRAWING NO.	930-118P-51A
ITEM NO.	930-118P-51A

1 2 3 4 5 6 7 8 RD-DK-1807