

QMA1121A1-AT30GS-223U-50		REVISIONS			
DRAWING NO.	REV:	DESCRIPTION	DATE	ECO	APPR
THIRD ANGLE PROJ.	1	RELEASE TO MFG.	01/16/06		TONY

- NOTES:
- MATERIALS AND FINISHES:
 BODY - BRASS, ALBALOY PLATING
 OUTER CONTACT - WHITE BRONZE(PS2), ALBALOY PLATING
 CONTACT PIN - BRASS, GOLD PLATING
 INSULATOR - PTFE, NATURAL
 - ELECTRICAL:
 A. IMPEDANCE: 50 OHM
 B. DIELECTRIC WITHSTANDING VOLTAGE: 1000 VRMS, MIN.
 - MECHANICAL:
 A. DURABILITY: 500 CYCLES MIN.
 B. TEMPERATURE RANGE: - 65°C to +165°C
 - CRIMPED FERRULE
 HEX. CRIMP SIZE .213"
 - CONTACT PIN TO SOLDER

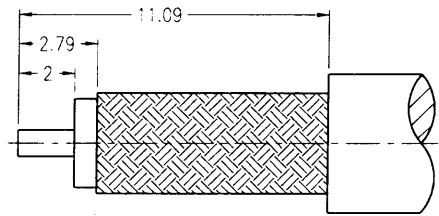

RECOMMENDED
CABLE STRIPPING DIM'S

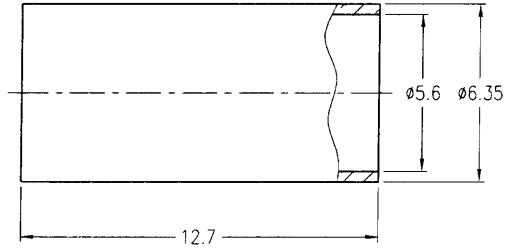
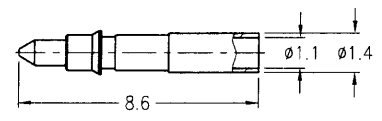
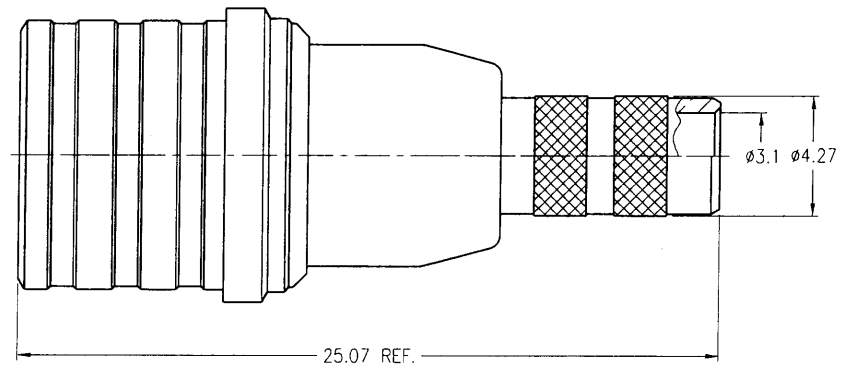

CUSTOMER OUTLINE DRAWING
ALL OTHER SHEETS ARE FOR INTERNAL USE ONLY

UNLESS OTHERWISE SPECIFIED, DIMENSIONS ARE IN METRIC AND TOLERANCES ARE: 0.5 - 6mm ±0.1mm 6 - 30mm ±0.2mm 30 - 120mm ±0.5mm ANGLES ±1°	MATERIAL	DRAWN TONY	DATE 16-Jan-06	TITLE QMA 50 OHM PLUG (FOR RG-142A/U, 223/U, 400/U, 55/U CABLE)	Amphenol RF Danbury, CT, USA Tainan, Taiwan Shenzhen, China www.amphenolrf.com	
	REFERENCE	ENGINEER LIGHTER	DATE 16-Jan-06	APPROVED <i>Andy C</i> 1/17/06	ITEM NO. 701121AAA26AR5F	SCALE: 4/1 SHEET 2 OF 2
NOTICE - These drawings, specifications, or other data (1) are, and remain the property of Amphenol Corp. (2) must be returned upon request; and (3) are confidential and not to be disclosed to any person other than those to whom they are given by Amphenol Corp. The furnishing of these drawings, specifications, or other data by Amphenol Corp., or to any other person to anyone for any purpose is not to be regarded by implication or otherwise in any manner licensing, granting rights or permitting such holder or any other person to manufacture, use or sell any product, process or design, patented or otherwise, that may in any way be related to or disclosed by said drawings, specifications, or other data.	FINISH	CAD FILE	CODE ID	DWG SIZE	DRAWING NO.	REV
PART NO.		F:\DWG\QMA\1121A1\223U-50\AT30GSSZ	74868	B	QMA1121A1-AT30GS-223U-50	1