

RoHS  
COMPLIANT

Ⓞ  $4.83 \pm 0.05$  [.190 ± .002]

$3.18 \pm 0.05$  [.125 ± .002]

$2.79 \pm 0.05$  [.110 ± .002]  
 $1.57$  [.062]  
 $RO.35 \pm 0.13$  [R.010 ± .005]

$1.27$  [.050]  
 $2.29$  [.090]  
 $3.18 \pm 0.13$  [.125 ± .005]

$5.84 \pm 0.13$  [.230 ± .005]  
 $9.91 \pm 0.25$  [.390 ± .010]

$3.61$  [.142]

$0.13^{+0.08}_{-0.05}$  [.005 ± .002]

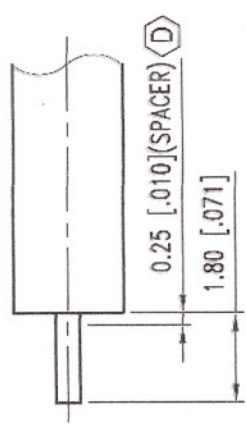
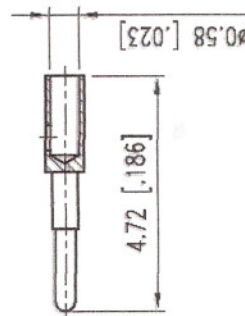

RECOMMENDED  
CABLE STRIPPING DIMS

SPECIFICATIONS :

1. IMPEDANCE : 50 OHMS
2. GOLD: 50~100 micrometers OVER BeCu (BODY)  $\text{C}$   
(WITH COPPER UNDER PLATED 100~200 micrometers)
3. GOLD FINISH : 50~100 micrometers OVER BeCu (PIN)  $\text{C}$   
(WITH COPPER UNDER PLATED 100~200 micrometers)
4. REMOVED ALL BURRS & BREAK ALL SHARP EDGES
5.  $\text{C}$  IMPORTANT DIMENSION TO CHECK.

REV	ECN NO.	NAME	DATE	TOLERANCE: DECIMALS:	APPROVED	UNIT
D	99-0296	JERRY	99/07/10	.XX ± 0.08 .X ± 0.13	<i>J. J. J.</i>	mm
C		JERRY	99/06/24		99/06/03	
C		JERRY	99/06/12		99/06/03	
Drawn		Checked	Approved	Unit		
<i>JERRY</i>		<i>JERRY</i>	<i>J. J. J.</i>	mm		
99/06/03		99/06/03	99/06/03			
File Path: E:\CONNECTOR\SMA				A4		
145-M161-70-DX		1	PTFE	NONE		
145-M161-40-AZ		1	BeCu	GOLD		
145-M161-10-AZ		1	BeCu	GOLD		
ITEM	DESCRIPTION	PART NUMBER	QTY	MATERIAL	FINISH	
3	dielectric	145-M161-70-DX	1	PTFE	NONE	
2	Pin	145-M161-40-AZ	1	BeCu	GOLD	
1	Body	145-M161-10-AZ	1	BeCu	GOLD	
TITLE: SMP PLUG FOR .086' CABLE						
DWG. NO. 145-M16E/111						
SCALE 10/1						
SHEET 1 OF 1						
SERIES SMP						